

Steeltapp™

Fastener Material
Carbon Steel
Fastener Application
Steel Sheets Into Steel / Timber Substrates

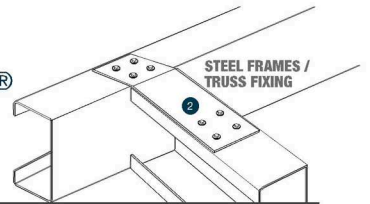

CORROSHIELD®
CONSTRUCTION FASTENERS



Fastener Material
Stainless Steel
Fastener Application
Aluminum Sheets Into Steel / Timber Substrates

Alutapp™

1 **CSMT 10-24 x 16mm - W**
CONCEALED FIXING FASTENERS (MILD STEEL < 4.5mm)



2 **SRTTR 12-14 x 20mm**
TRUSS FIXING FASTENERS (MILD STEEL < 5.5mm)



3 **CSMT 14-14 x 22mm - R**
STITCHING FASTENERS (THIN SHEETS < 2.0mm)



4 **CSMT 12-14 x 25mm**
VALLEY FIXING FASTENERS (MILD SHEETS < 5.5mm)



5 **CSMT 12-24 x 32mm - 5**
VALLEY FIXING FASTENERS (THICK STEEL < 12.5mm)



6 **CSMT 12-14 x 45mm - DS**
CREST FIXING FASTENERS (MILD STEEL < 5.5mm)



7 **CSTT 12-11 x 50mm - DS**
CREST FIXING FASTENERS (TIMBER, MIN. 25mm)



8 **CSDT 12-14 x 50mm - DS**
CREST FIXING FASTENERS (MILD STEEL < 2.0mm and TIMBER, MIN. 25mm)



9 **SR4S 10-16 x 20mm - R**
STITCHING FASTENERS (MILD STEEL < 1.5mm)



10 **SRBM 12-14 x 40mm - H**
VALLEY FIXING FASTENERS (MILD STEEL < 5.0mm)



11 **SRBM 12-14 x 80mm - H**
VALLEY FIXING FASTENERS (MILD STEEL < 5.0mm)

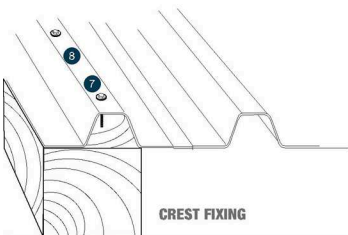

CREST FIXING

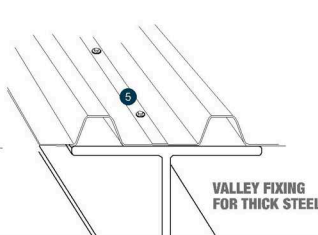

VALLEY FIXING FOR THICK STEEL

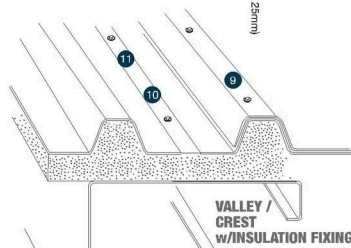

VALLEY / CREST w/INSULATION FIXING

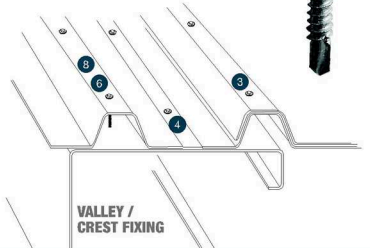

VALLEY / CREST FIXING

Australia Austria Bangladesh Brunei China Germany Ghana India Indonesia Kenya Kuwait Malaysia Nepal Qatar Romania Saudi Arabia Singapore Slovenia South Africa Sri Lanka Taiwan Tanzania Thailand Timor Leste Uganda United Arab Emirates United Kingdom Vietnam Zambia

www.engineering-edge.com